

# Front Fork Scale

The highest quality front fork scale for refuse weighing applications

Our Fork Scale fits all types of front loaders in refuse applications. The rugged bolt-on weight sensing forks replace the truck's existing forks. Working in conjunction with the Vulcan V600 electronics, the system measures the weight collected from each container and tracks the total net payload weight. The V600 meter offers data acquisition and expansion capabilities.



FRONT FORK SCALE

V600 METER

## Key Features:

- Flexible - manual, static and weigh-in-motion options available (Consult factory or appropriate applications note for details)
- Easy installation- replaces your existing forks
- Bolt on - forks bolt to mounting kits that can be welded to various types of cross tubes
- Rugged - machined from a solid bar of high strength alloy steel, uses a reliable, double sealed military style connector
- Light weight design - negligible impact on the trucks weight
- Data acquisition - can record up to 1500 events including: date, time, pick-up weight, stop number and exceptions
- Lockout feature - allows full operation of scales while safeguarding against accidental changing of calibration
- Expansion capabilities - serial interface to printers, on-board computers, wireless communication systems, and other devices
- Additional Cross Tube Assemblies are available which eliminate the need to weld saving eight to ten hours of instation time

5920 South 194th Street | Kent, WA 98032 | USA  
Ph: Toll Free 800-237-0022 or +1-253-872-1910  
E-mail: [sionboard@vpgsensors.com](mailto:sionboard@vpgsensors.com)

[sionboard.com](http://sionboard.com)

**SI**  
**ON-BOARD**  
WEIGHING  
A VPG Brand

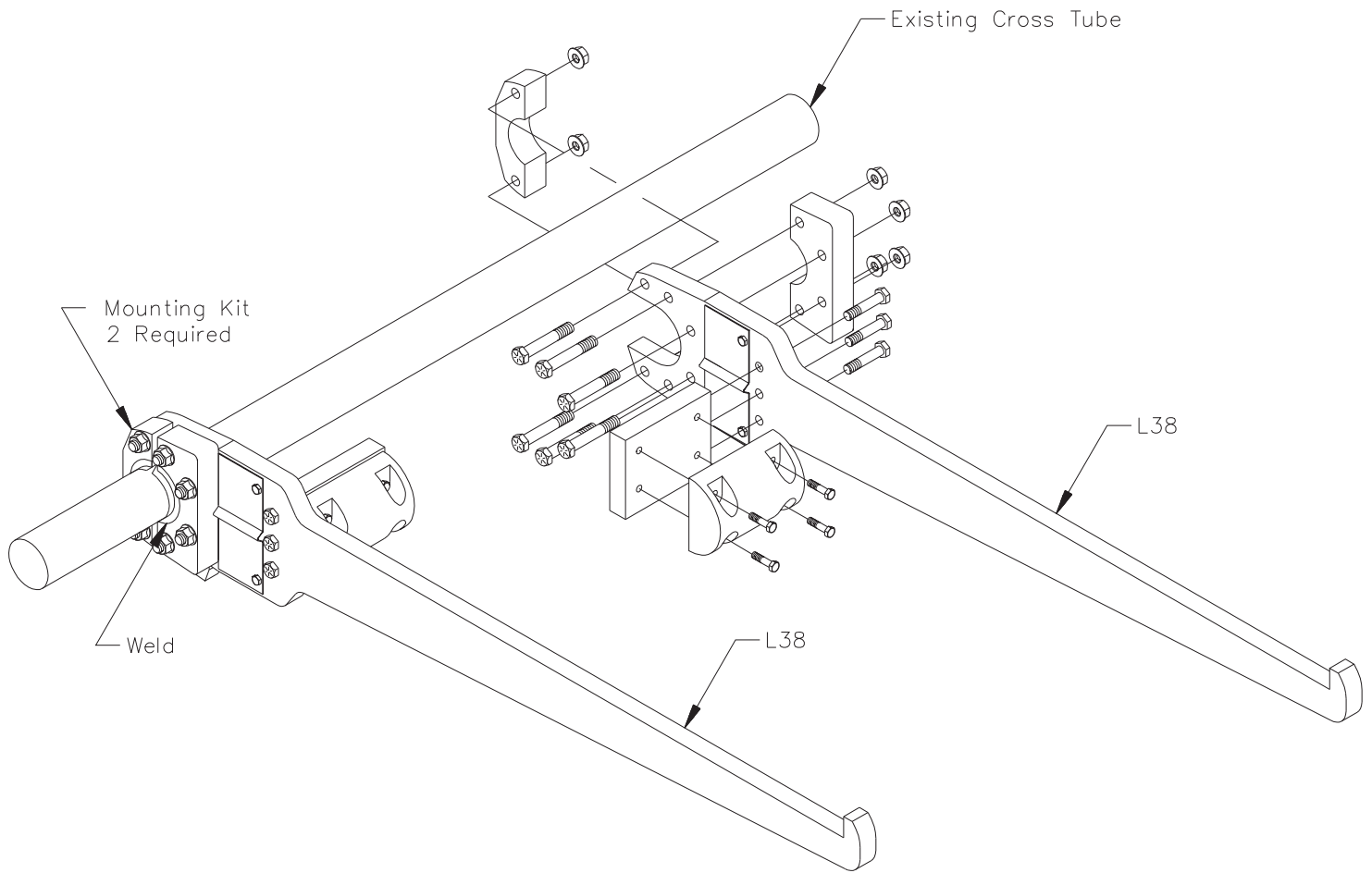

**CROSS TUBE  
MOUNTING KITS (Hxx)**

- 3.5" ROUND
- 4" ROUND
- 4" SQUARE
- 4.5" ROUND
- UNIVERSAL

**NOTE:** Consult factory for appropriate mounting kit

**SPECIFICATION:**

**CAPACITY:** 10,000 lb

**LOAD CELL ACCURACY:** a: within 1% of Individual Pickup Weight  
 b: within .5% of Net Payload Weight  
**Note:** Actual operational accuracy may vary.  
 Consult factory for details

**MATERIAL:** High strength alloy steel

**FINISH:** Primed for painting

**REPRESENTED BY:**